



TOTAL Sketch by a la mode

Area Calculations Summary

Living Area

First Floor 2231.76 Sq ft

Total Living Area (Rounded): 2232 Sq ft

Non-living Area

Wood Deck 298.51 Sq ft

2 Car Attached 788.57 Sq ft

Wood Deck 178.4 Sq ft

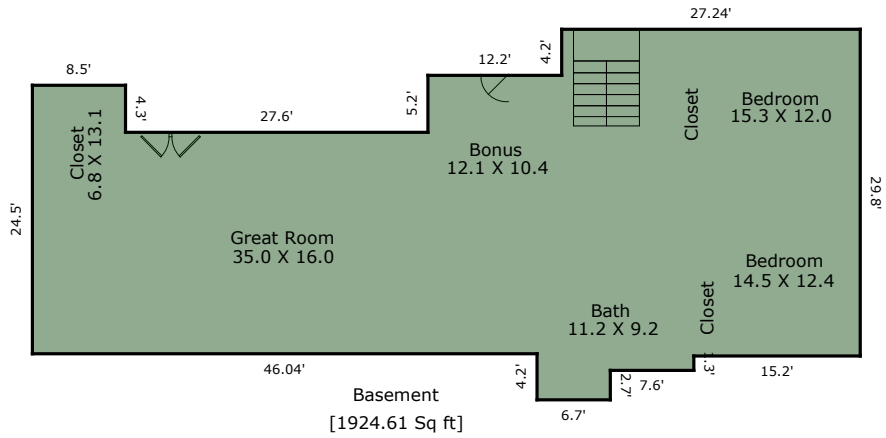

TOTAL Sketch by a la mode

Area Calculations Summary

Non-living Area

Basement 1924.61 Sq ft

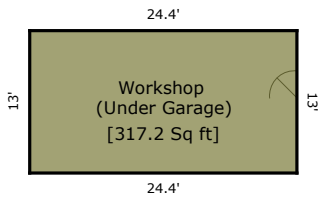

TOTAL Sketch by a la mode

Area Calculations Summary

Non-living Area

Basement

317.2 Sq ft

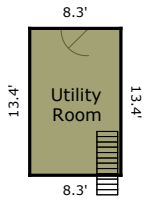

TOTAL Sketch by a la mode

Area Calculations Summary

Non-living Area

Basement

111.22 Sq ft

Area Calculations Summary

Living Area		Calculation Details	
First Floor	2231.76 Sq ft	29.8×15.2	= 452.96
		12.04×4.2	= 50.58
		24.5×8.5	= 208.25
		26.9×7.6	= 204.44
		16.64×5.2	= 86.54
		44.24×20.2	= 893.7
		12.7×10.7	= 135.89
		5.74×6.96	= 39.95
		7.04×2.9	= 20.42
		4.24×2.8	= 11.88
		4.24×4.24	= 18
		$0.5 \times 4.24 \times 4.24$	= 9
		9×6	= 54
		$0.5 \times 6 \times 6$	= 18
		4.2×6.7	= 28.14
Total Living Area (Rounded):	2232 Sq ft		
Non-living Area			
Wood Deck	298.51 Sq ft	16×14	= 224
		5.66×10.34	= 58.51
		$0.5 \times 5.66 \times 5.66$	= 16
2 Car Attached	788.57 Sq ft	2.9×24.4	= 70.76
		21.3×33.7	= 717.81
Wood Deck	178.4 Sq ft	24.3×4	= 97.2
		16.3×4	= 65.2
		$0.5 \times 4 \times 4$	= 8
		$0.5 \times 4 \times 4$	= 8
Basement	1924.61 Sq ft	29.8×15.2	= 452.96
		6.7×2.7	= 18.09
		31.1×12.04	= 374.52
		2.26×1.5	= 3.39
		25.4×12.2	= 309.88
		20.2×27.6	= 557.52
		8.5×24.5	= 208.25
Basement	317.2 Sq ft	24.4×13	= 317.2
Basement	111.22 Sq ft	13.4×8.3	= 111.22