

TOTAL Sketch by a la mode

Area Calculations Summary

Living Area

First Floor 1703.71 Sq ft

Total Living Area (Rounded): 1704 Sq ft

Non-living Area

Front Porch 385.8 Sq ft

Patio 635.06 Sq ft

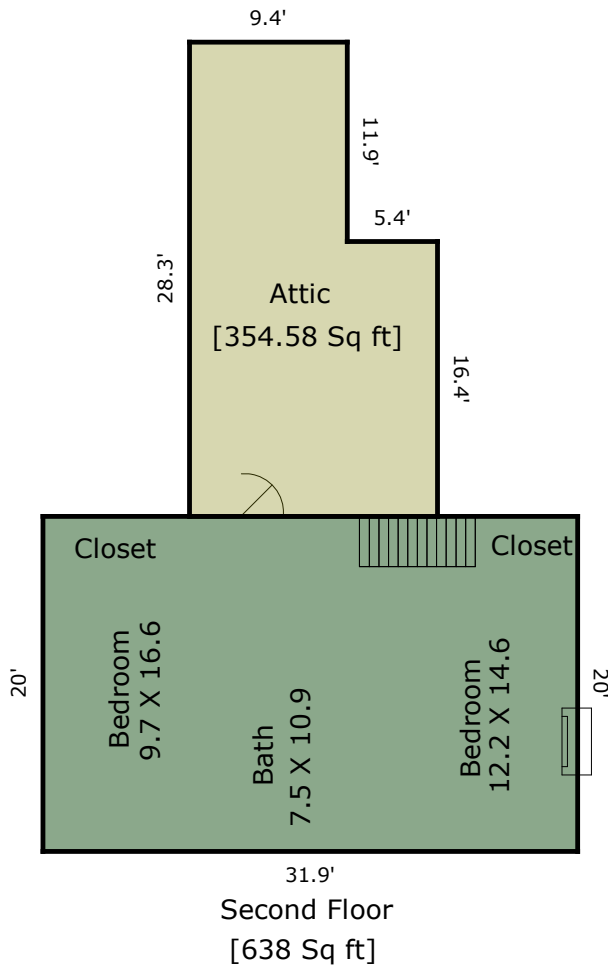

TOTAL Sketch by a la mode

Area Calculations Summary

Living Area

Second Floor

638 Sq ft

Total Living Area (Rounded):

638 Sq ft

Non-living Area

Attic

354.58 Sq ft

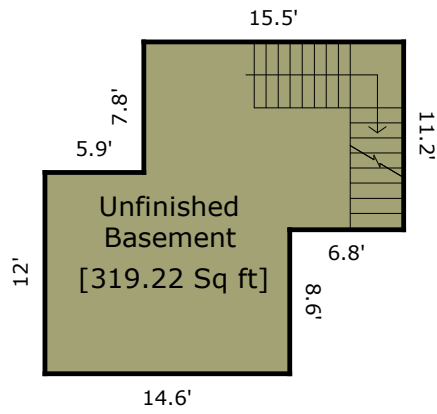

TOTAL Sketch by a la mode

Area Calculations Summary

Non-living Area

Basement	319.22 Sq ft
----------	--------------

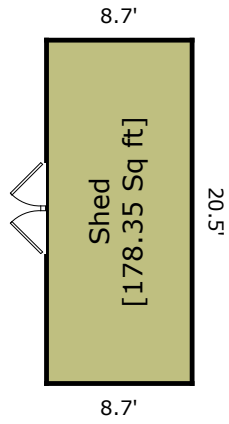

TOTAL Sketch by a la mode

Area Calculations Summary

Non-living Area

Shed	178.35 Sq ft
------	--------------

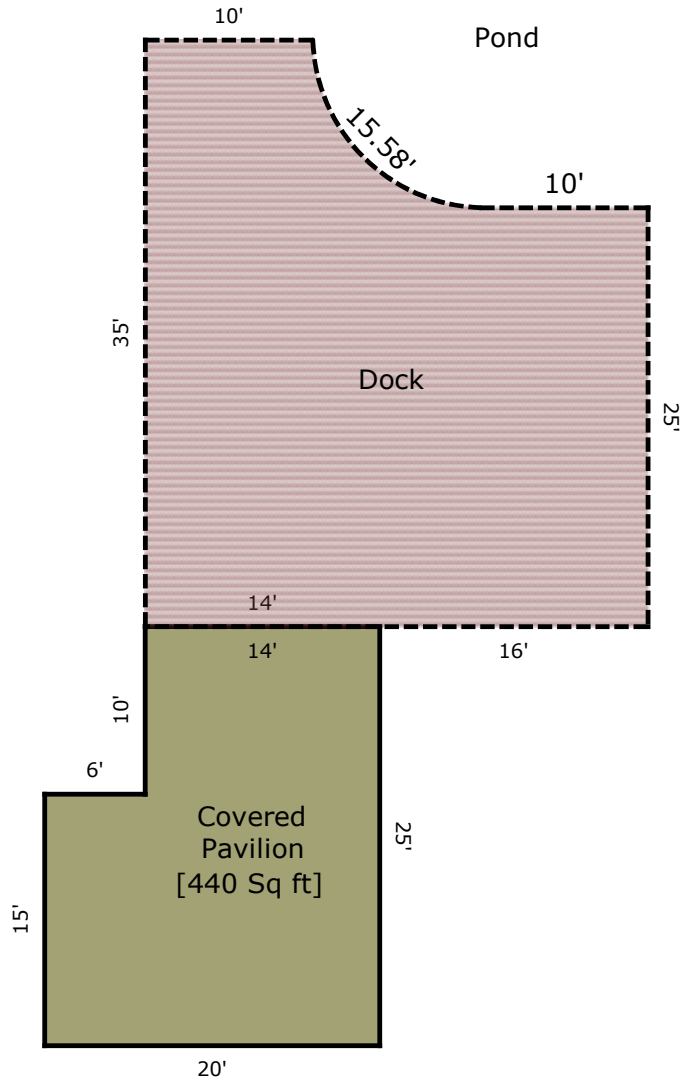

TOTAL Sketch by a la mode

Area Calculations Summary

Non-living Area

Wood Deck	872.79 Sq ft
Pavilion	440 Sq ft

Area Calculations Summary

Living Area		Calculation Details	
First Floor	1703.71 Sq ft	31.9×49.3 8.4×15.6	= 1572.67 = 131.04
Second Floor	638 Sq ft	20×31.9	= 638
Total Living Area (Rounded):		2342 Sq ft	
Non-living Area			
Front Porch	385.8 Sq ft	9×8.2 12×26	= 73.8 = 312
Patio	635.06 Sq ft	$0.5 \times 14.6 \times 1.84$ $0.5 \times 1.5 \times 4.5$ $0.5 \times 4.5 \times 1.84$ 14.6×4.5 $0.5 \times 5.66 \times 5.66$ $0.5 \times 5.66 \times 2.31$ 17.94×5.66 $0.5 \times 10 \times 4.09$ 25.91×10 $0.5 \times 0.2 \times 0.5$ 19.8×0.5 $0.5 \times 9.7 \times 1.5$ $0.5 \times 1.8 \times 4.5$ $0.5 \times 4.5 \times 3.3$ 5×4.5 Negative Arc Arc Arc Arc Negative Arc Arc Arc Arc	= 13.45 = 3.38 = 4.14 = 65.69 = 16 = 6.55 = 101.47 = 20.45 = 259.09 = 0.05 = 9.9 = 7.28 = 4.05 = 7.42 = 22.5 = 5.4 = 1.6 = 10.29 = 87.24 = 9.48 = 2.92 = 1.87 = 4.6
Attic	354.58 Sq ft	14.8×16.4 11.9×9.4	= 242.72 = 111.86
Basement	319.22 Sq ft	11.2×6.8 8.7×7.8 12×14.6	= 76.16 = 67.86 = 175.2
Shed	178.35 Sq ft	20.5×8.7	= 178.35
Wood Deck	872.79 Sq ft	30×25 10×10 $0.5 \times 10 \times 10$ Negative Arc	= 750 = 100 = 50 = 27.21
Pavilion	440 Sq ft	20×15 10×14	= 300 = 140