

TOTAL Sketch by a la mode

Area Calculations Summary

Living Area		Calculation Details
First Floor	579.8 Sq ft	$22.3 \times 26 = 579.8$
Total Living Area (Rounded):		580 Sq ft
Non-living Area		
Wood Deck	128 Sq ft	$8 \times 16 = 128$
Front Porch	24 Sq ft	$6 \times 4 = 24$

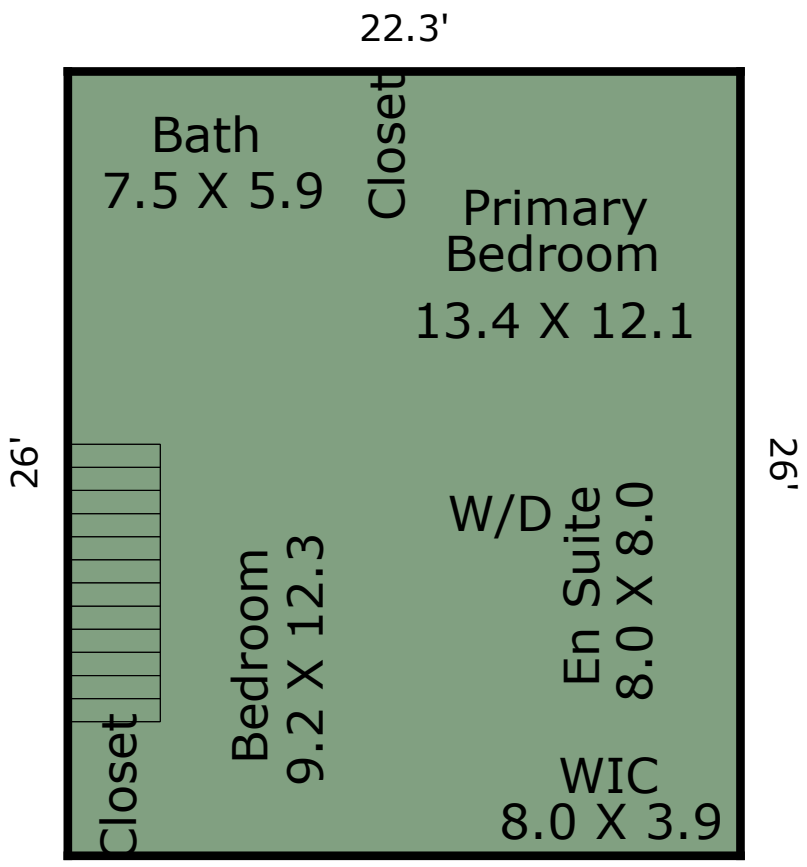

Second Floor^{22.3'}
 [579.8 Sq ft]

TOTAL Sketch by a la mode

Area Calculations Summary

Living Area		Calculation Details
Second Floor	579.8 Sq ft	22.3 × 26 = 579.8
Total Living Area (Rounded):	580 Sq ft	

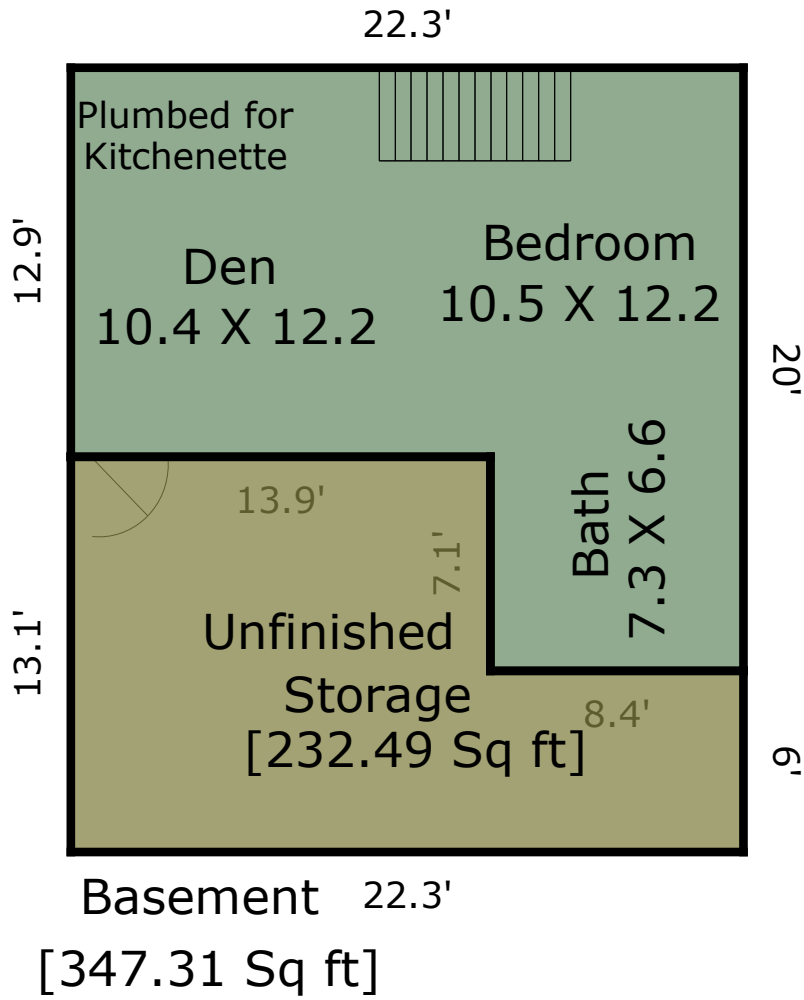

TOTAL Sketch by a la mode

Area Calculations Summary

Non-living Area

Basement	347.31 Sq ft	$12.9 \times 13.9 = 179.31$
		$20 \times 8.4 = 168$
Basement	232.49 Sq ft	$13.1 \times 13.9 = 182.09$
		$6 \times 8.4 = 50.4$